

DC Square-body Fuses Sizes 300 - 302 - 2x302 SR Brackets size 300 - 2400V DC

SRE from 20 to 180 A

Dimensions

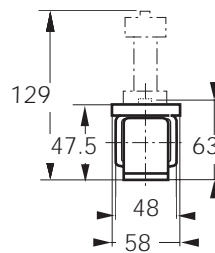
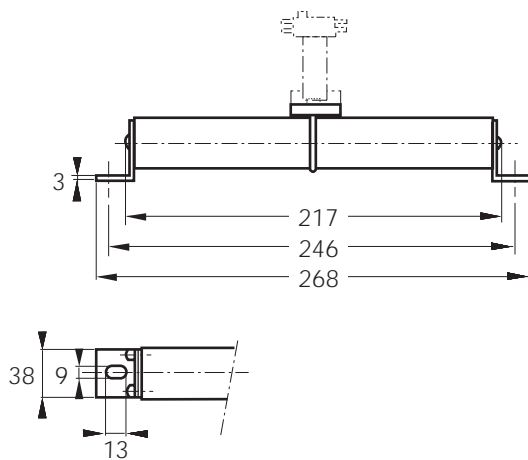

Weight: 1150 g

Main Characteristics

Size	Current rating I_N (A)	Breaking Capacity	Watts loss		Max. I^2t @ 2000 V		Designation	Ref. Number	Catalog Number
			0.8 I_N (W)	I_N (W)	L/R = 15 ms (A ² S)	L/R = 45 ms (A ² S)			
300	20	@ 2400 V DC 100 kA L/R = 15 ms	18	36	150	260	CC 24 SRE 300 QF 0020	X075299	D300SE24C20QF
	25		21	42	260	460	CC 24 SRE 300 QF 0025	W075298	D300SE24C25QF
	32		22	43	310	540	CC 24 SRE 300 QF 0032	G079471	D300SE24C32QF
	40		26	51	530	920	CC 24 SRE 300 QF 0040	H079472	D300SE24C40QF
	50		32	62	750	1300	CC 24 SRE 300 QF 0050	J079473	D300SE24C50QF
	63	35	69	1650	2900	CC 24 SRE 300 QF 0063	K079474	D300SE24C63QF	
	80	38	75	3700	6500	CC 24 SRE 300 QF 0080	L079475	D300SE24C80QF	
	100	41	80	8000	14000	CC 24 SRE 300 QF 0100	M079476	D300SE24C100QF	
	125	49	95	14000	25000	CC 24 SRE 300 QF 0125	N079477	D300SE24C125QF	
	160	50	96	34000	60000	CC 24 SRE 300 QF 0160	P079478	D300SE24C160QF	
180	51	98	57000	100000	CC 24 SRE 300 QF 0180	Q079479	D300SE24C180QF		

Pack: 1 piece

Microswitch MC 2R 3E 1-5N BS Ref. Number: J310025



DC Square-body Fuses Sizes 300 - 302 - 2x302 SR Brackets size 300 - 2400V DC



SRE from 20 to 180 A

Electrical characteristics DC applications data

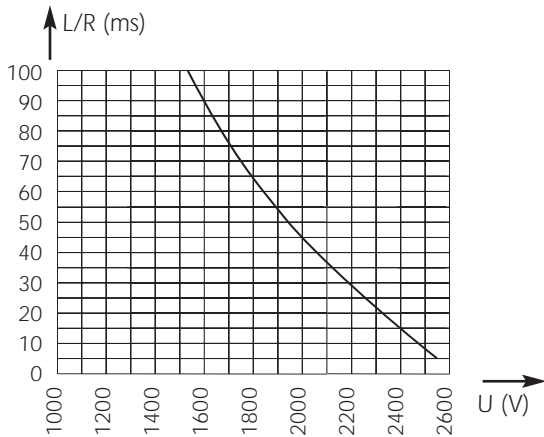

Above: Curve indicates maximum permissible value of time constant L/R as a function of DC working voltage

Max. AC voltage (50/60 Hz):
 2000 V with breaking capacity of 80 kA

Time vs. current characteristics

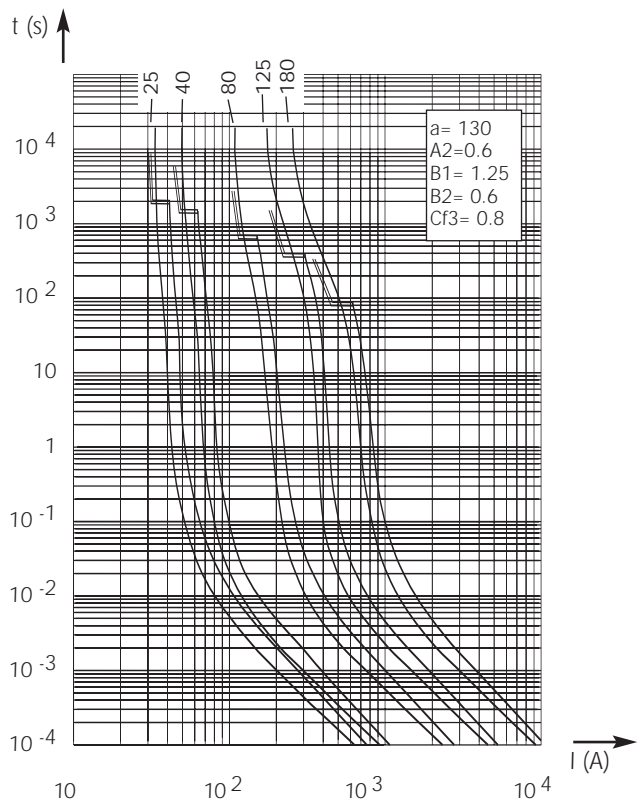
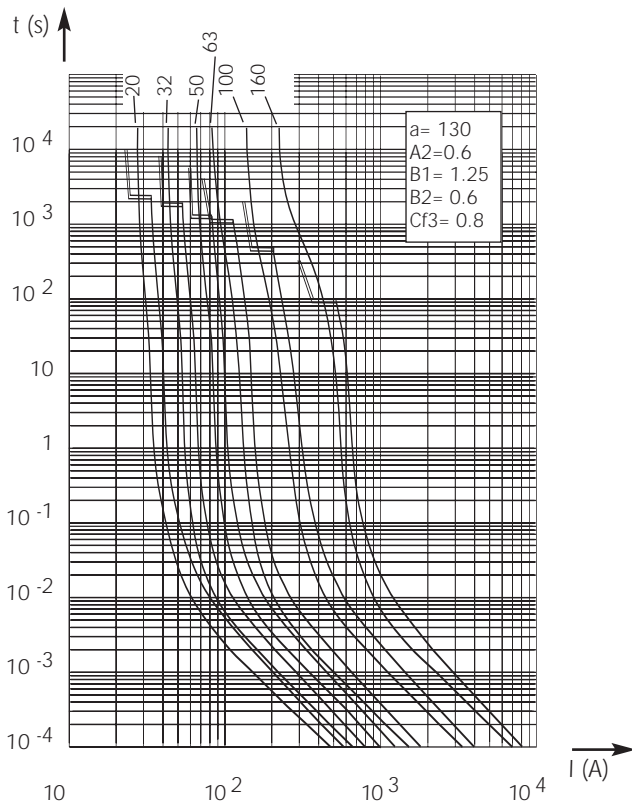

Peak arc voltage vs. working voltage

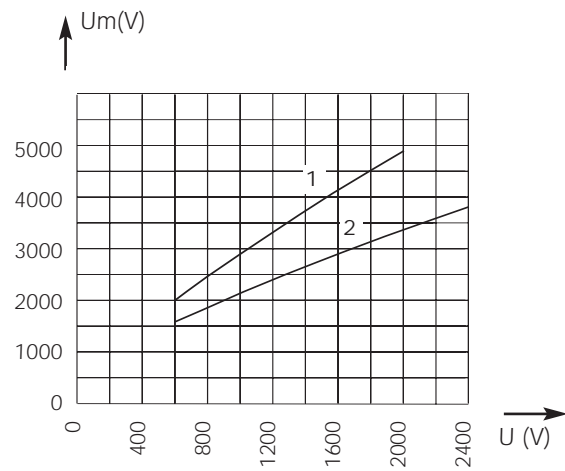

1 : L/R = 45 ms
 2 : L/R = 15 ms

Above: Curves indicate for various time constants L/R the peak arc voltage which may appear across fuse terminals, vs. DC working voltage

Above: Curves indicate, for each rated current, pre-arcing time vs. R.M.S. pre-arcing current.

DC Square-body Fuses Sizes 300 - 302 - 2x302 SR Brackets size 302 - 2400V DC

SRD - SRF from 160 to 400 A

Dimensions

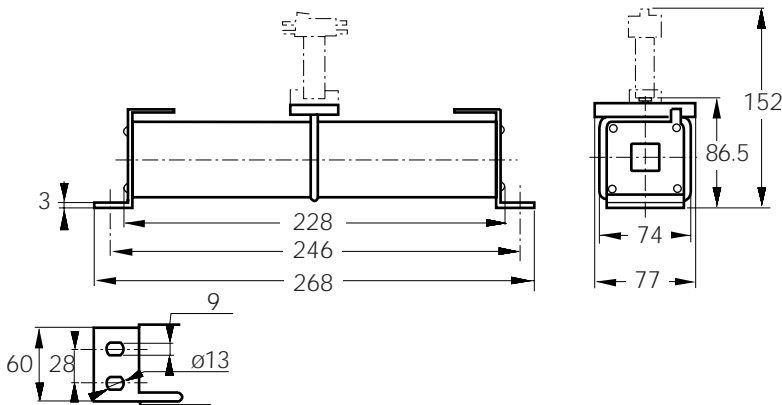

Weight: 1830 g

Main Characteristics

Size	Current rating I_N (A)	Breaking Capacity	Watts loss		Max. I^2t @ 2000 V		Designation	Ref. Number	Catalog Number
			$0.8 I_N$ (W)	I_N (W)	L/R = 15 ms (A ² S)	L/R = 45 ms (A ² S)			
302	160	@ 2400 V DC	71	142	18,500	32,000	CC 24 SRD 302 QF 0160	J 076644	D302SD24C160QF
	200	100 kA	76	149	38,000	66,000	CC 24 SRD 302 QF 0200	R079480	D302SD24C200QF
	250	L/R = 15 ms	90	179	68,000	120,000	CC 24 SRD 302 QF 0250	S079481	D302SD24C250QF
	315		94	186	150,000	250,000	CC 24 SRD 302 QF 0315	T079482	D302SD24C315QF
	350	@ 2000 V DC	95	187	230,000	400,000	CC 24 SRD 302 QF 0350	V079483	D302SD24C350QF
	400	100 kA L/R = 45 ms	96	188	195,000	325,000	CC 24 SRF 302 QF 0400	V075297	D302SF24C400QF

Microswitch MC 2R 3E 1-5N BS Ref. Number: J310025

Pack: 1 piece



DC Square-body Fuses Sizes 300 - 302 - 2x302 SR Brackets size 302 - 2400V DC



SRD - SRF from 160 to 400 A

Electrical characteristics

DC applications data

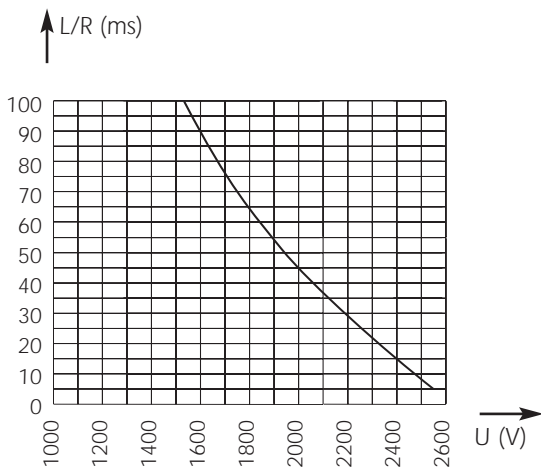

Above: Curve indicates maximum permissible value of time constant L/R as a function of DC working voltage

Max. AC voltage (50/60 Hz):
 2000 V with breaking capacity of 80 kA

Time vs. current characteristics

Peak arc voltage vs. working voltage

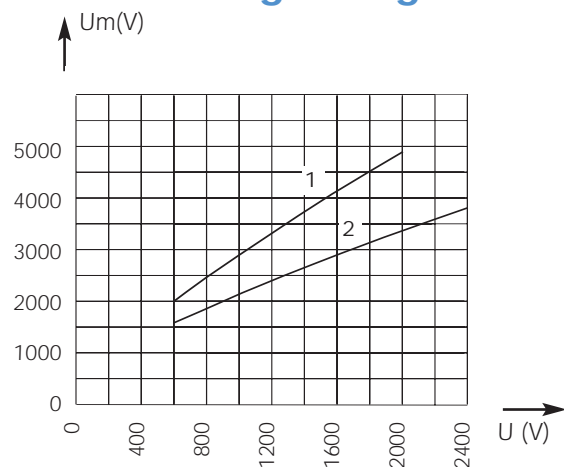

1 : L/R = 45 ms
 2 : L/R = 15 ms

Above: Curves indicate for various time constants L/R the peak arc voltage which may appear across fuse terminals, vs. DC working voltage

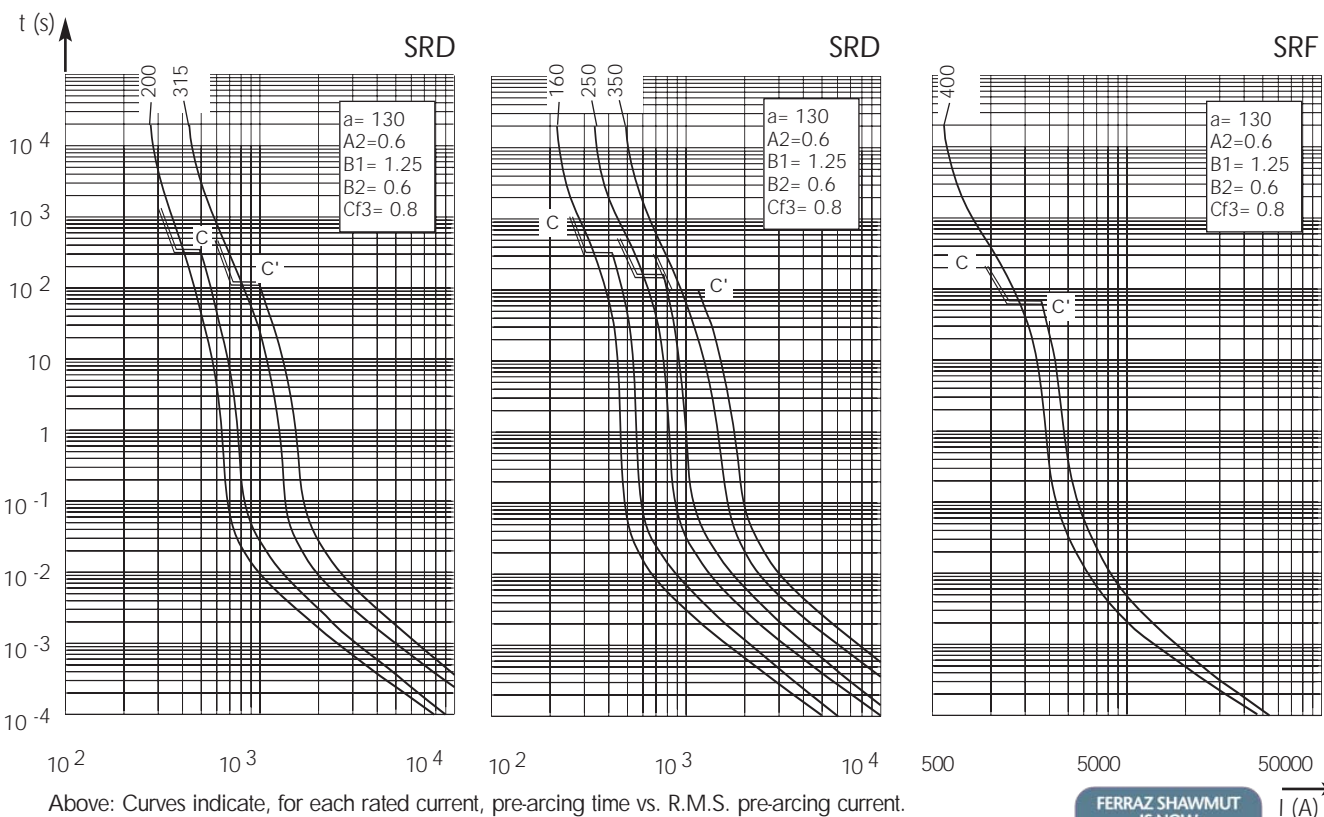

Above: Curves indicate, for each rated current, pre-arcing time vs. R.M.S. pre-arcing current.

DC Square-body Fuses Sizes 300 - 302 - 2x302 SR size 2x302 - 2400V DC

SRD - SRF from 400 to 800 A

Dimensions

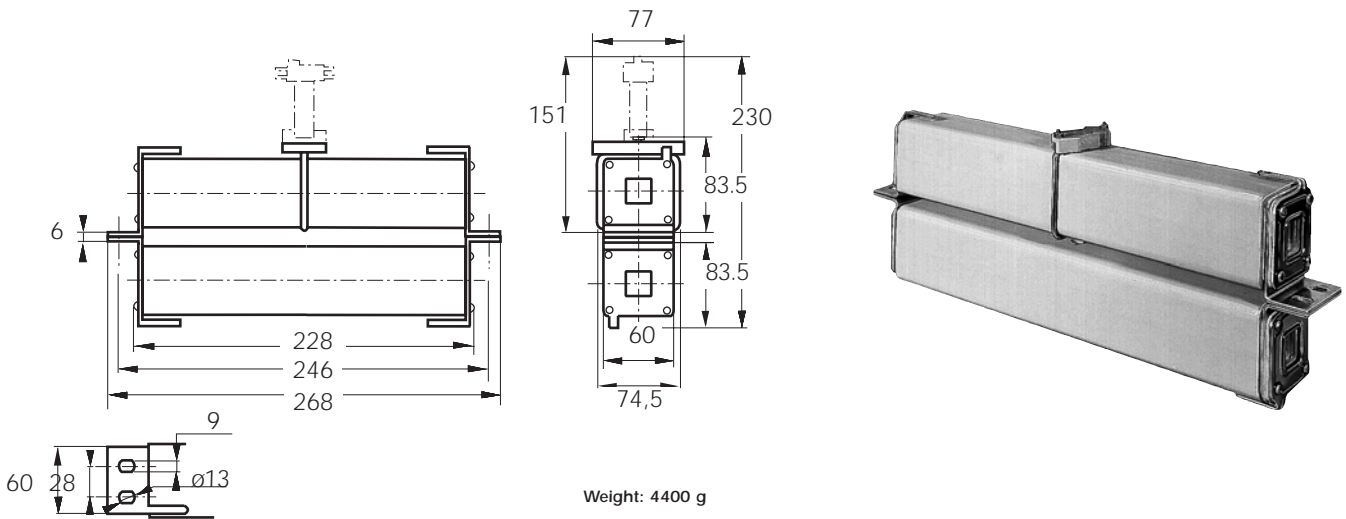

Main Characteristics

Size	Current rating I_N (A)	Breaking Capacity	Watts loss		Max. I^2t @ 2000 V		Designation	Ref. Number	Catalog Number
			$0.8 I_N$ (W)	I_N (W)	L/R = 15 ms (A ² S)	L/R = 45 ms (A ² S)			
2x302	400	@ 2400 V DC	160	313	155,000	265,000	CC 24 SRD 2302 QF 400	K084925	D2302SD24C400QF
	500	100 kA	189	376	275,000	480,000	CC 24 SRD 2302 QF 500	L084926	D2302SD24C500QF
	630	L/R = 15 ms	197	390	600,000	10^6	CC 24 SRD 2302 QF 630	M084927	D2302SD24C630QF
	700	@ 2000 V DC	200	393	920,000	$1.6 \cdot 10^6$	CC 24 SRD 2302 QF 700	N084928	D2302SD24C700QF
	800	100 kA L/R = 45 ms	205	395	780,000	$1.3 \cdot 10^6$	CC 24 SRF 2302 QF 800	T075296	D2302SF24C800QF

Microswitch MC 2R 3E 1-5N BS Ref. Number: J310025

Pack: 1 piece

Protistor DC fuses

DC Square-body Fuses Sizes 300 - 302 - 2x302 SR size 2x302 - 2400V DC

SRD - SRF from 400 to 800 A

Electrical characteristics

DC applications data

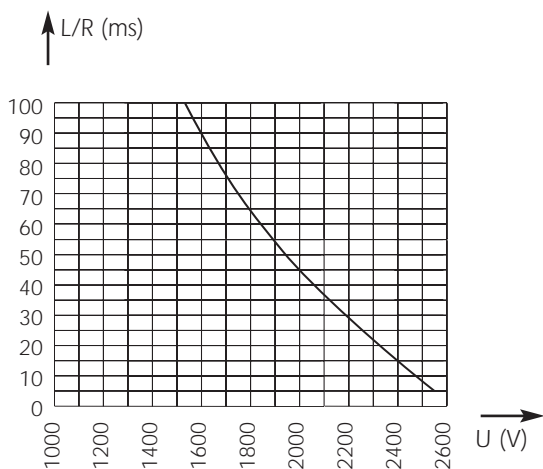

Above: Curve indicates maximum permissible value of time constant L/R as a function of DC working voltage

Max. AC voltage (50/60 Hz):
 2000 V with breaking capacity of 80 kA

Time vs. current characteristics

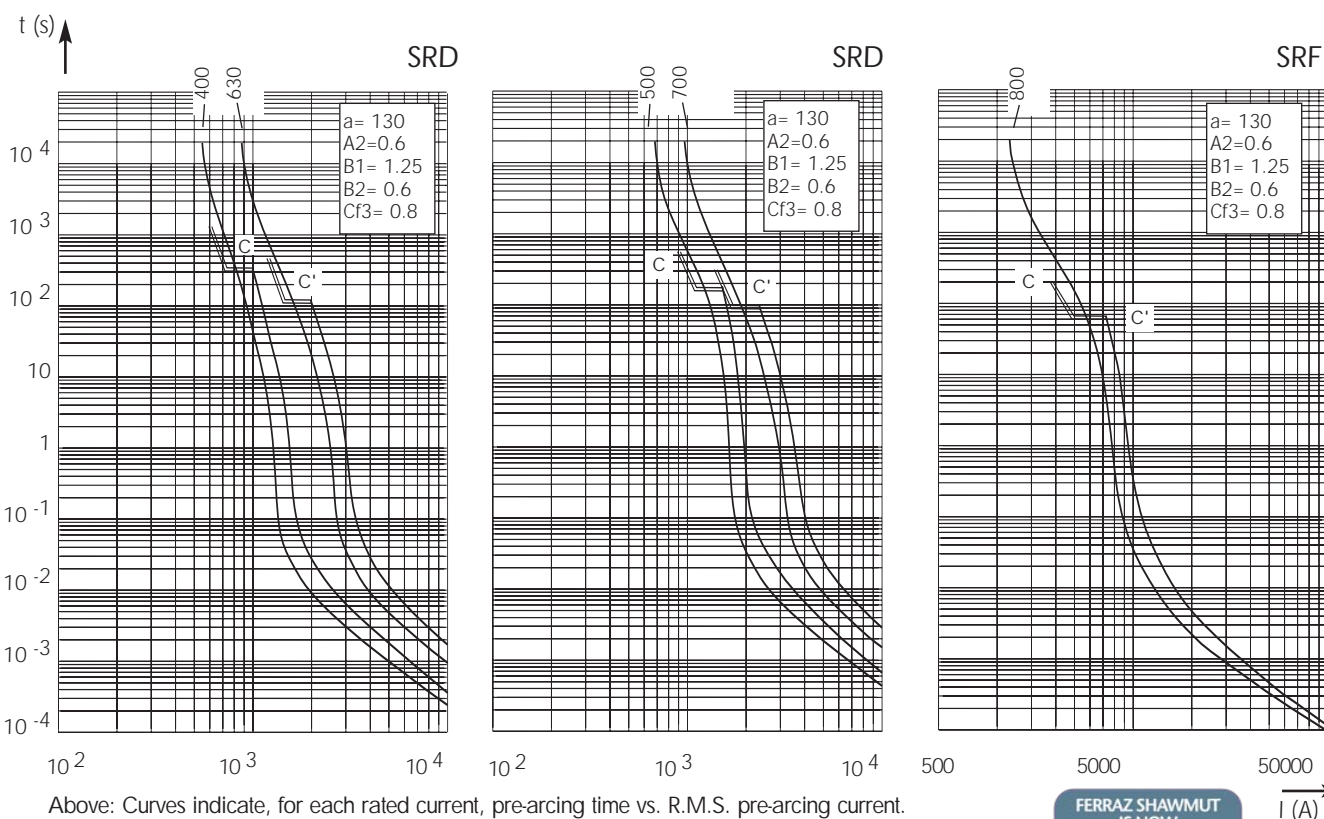

Above: Curves indicate, for each rated current, pre-arcing time vs. R.M.S. pre-arcing current.

Peak arc voltage vs. working voltage

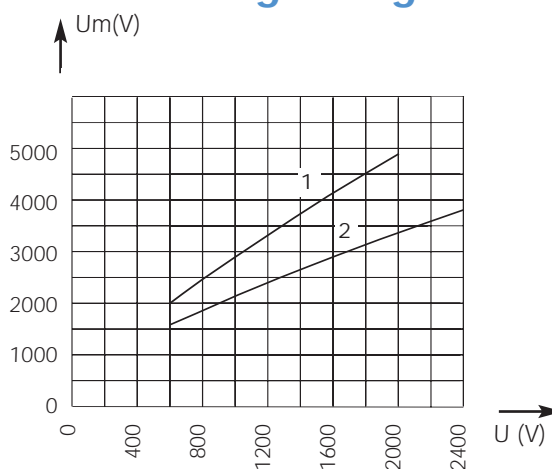

1 : $L/R = 45$ ms
 2 : $L/R = 15$ ms

Above: Curves indicate for various time constants L/R the peak arc voltage which may appear across fuse terminals, vs. DC working voltage